

# 产品规格书

# TECHNICAL SPECIFICATION

## 1.范围/Scope

**卓能**本规格书适用于下述 This specification is suitable for the performance

碱性电池 of following alkaline cell and its stack-up battery packs:

型号 : HQ-ALK-LR01

A:1.2-1.5mm	C:10.9-12.0mm
B:29.5-30.2mm	D:0.5-0.8mm

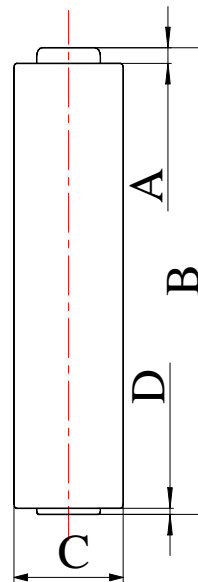

Chemical System: Zn/KOH—H<sub>2</sub>O/MnO<sub>2</sub>

Nominal voltage 标称电压: 1.5V

Heavy Metal Contents:

Hg	Cd	Pb
<1 ppm	<2 ppm	<120 ppm

## 2.额定值/Ratings

额定电压/Nominal Voltage		1.5V
使用温度范围 Temperature Range for operation	标准温度 Standard Temperature	20°C±2°C
	专用温度 Special Temperature	30°C±2°C
	高温 High temperature	45°C±2°C
相对湿度范围 Humidity Range for Storage	标准相对湿度 Standard Humidity	45%~75%
	专用相对湿度 Special Humidity	35%~65%

尺寸	直径/Diameter	LR1:10.9~12.0mm
Dimension	高度/Height	LR1:29.8±0.2 mm
近似重量/Approx weight		LR1:9.5~9.8g

### 3. 电性能/Electrical Characteristic

(条件:负载电阻 3.9Ω,精度±0.5%, 测量时间:0.3S,测量温度: 20°C±2°C。收货后 30 天内测试)

( condition: on-load resistance 3.9Ω,precision±0.5%,time:0.3S, temperature: 20°C±2°C。

Testing should be done within 30days upon the receipt of goods. )

	空载电压 /Off-load Voltage(V)	负载电压 /On-load Voltage(V)	瞬间电流 /Instance current(A)
新电/fresh Battery	1.610	1.500	8.0
室温存储 12 个月/stored for 12 months under Room Temp	1.580	1.480	5.0

### 4. 放电性能/ Discharge Characteristic

(条件:测量温度: 20°C±2°C。收货后 30 天内测试。)

(condition: temperature: 20°C±2°C. Testing should be done within 30days upon the receipt of goods)

参 考 标 准 /refere	放电条件/Discharge condition			最少平均放电时间 /Minimum average Discharge time	
	放电负载/ on-load resistance	每天放电时间 /Discharge time per day	终止电压 /end Voltage(V )	新 电 池 /fresh Battery	室温存储 12 个月 /stored for 12 months under Room Temp

nce standar d	3.9Ω	1h/d	0.9V	≥90min	≥80min
	300Ω	12h/d	0.9V	≥200h	≥190h
	5.1Ω	5min/d	0.9	≥150min	≥120min
	5.1Ω	24h/d	0.9	≥120min	≥100min

(验收标准：每一种放电条件取 9 只电池进行放电。平均放电时间等于或最少平均放电时间的规定值，而且放电时间少于规定值的 80% 的电池数不大于 1，则认为电池的放电时间符合要求。)

(Inspect standard: discharge 9 nos sample for each condition. It pass if average discharge time is equal to or more than minimum average value specified and the nos with discharge time less than 80% specified value is less than one. )

## 5 . 耐漏液性能/Anti-leakage characteristic

项目/Item	条件/Condition	期限/Period	特性/Characteristic	验收标准 /Inspect standard
过放电耐 漏性能 Feature of over-disch arge	连续放电，温度：20 °C±2°C相对 65±20RH on-load:10Ω temp: 20°C±2°C。 Huml: 65±20RH	连续放电 0.6V Uninterrupted discharge for 0.6V	电池变形不超出电 池尺寸的上限或没 有可见漏液情况。 Deformation is less than 0.2mm and no visual leakage	N=30,AC=0, Re=1
储存期耐 漏性能 feature of storage	温度：60°C±2°C相对 湿度:低于 90%RH temp60°C±2°C Huml:≤90%RH	20 天/20 days		N=30,AC=1, Re=2

## 6.安全性能/Safety Characteristic

项目/Item	条件/Condition	期限/Period	特 性 /Characteristic	验 收 标 准 /Inspect standard
短 路 性 能 /anti-short-circuit	温度/Temp: 20°C±2°C	24 小时/24hours	电 池 没 有 爆 炸 /no explosion	N=9,Ac=0,Re=1

## 7.标记/Marks:

在电池外标明以下内容:/the following message will be printed or stamped on the body of the battery:

- (1) 型号:/Model
- (2) 标称电压/Nominal Voltage
- (3) 极性/pole
- (4) 警告/Warning
- (5) 生产日期/到有效期日期 ( 附电池标版 )

## 8.电池存放期/Store period of battery

于常温及合适环境可储存 3 年/the battery is ok within 3 years under room temp and suit environment.

## 9.放电曲线/Discharge diagram 测试温度/test temp: 20°C±2°C

### LR1 电池放电曲线

a) Discharge Method : 3.9Ω 1h/d continuous (Fig. 1)

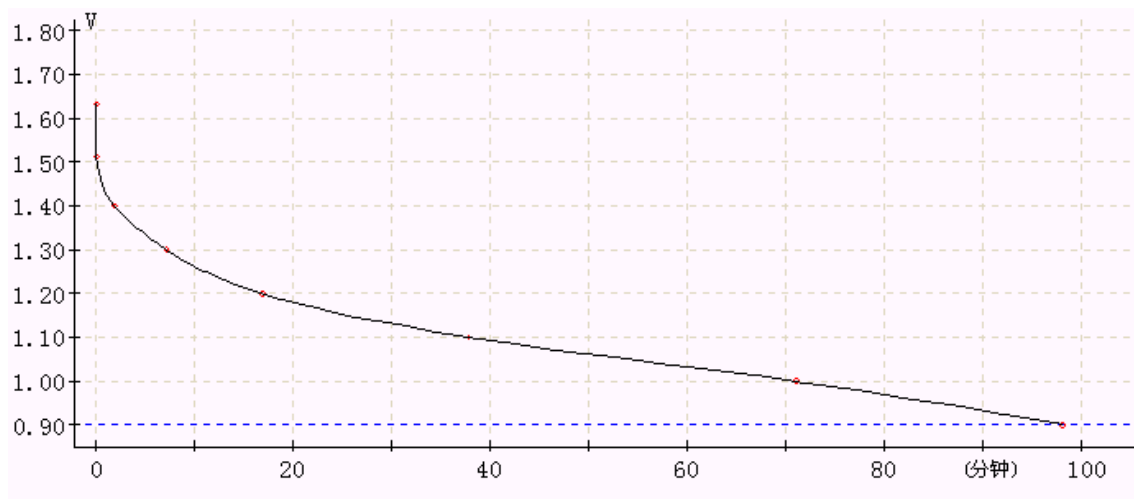

---

Discharge Time(mins)