

4 Installing the Display

- Place the adapter bracket mounted display onto the plate of Articulated Arm Assembly, as shown in fig 4.1.
- Tighten the safety screws through the mounting holes till the display can be fixed, do not over tighten! As shown in fig 4.1.

Important: Make sure the brackets mounted display is correctly mounted and the safety locking screws are locked safely before loosening the display.

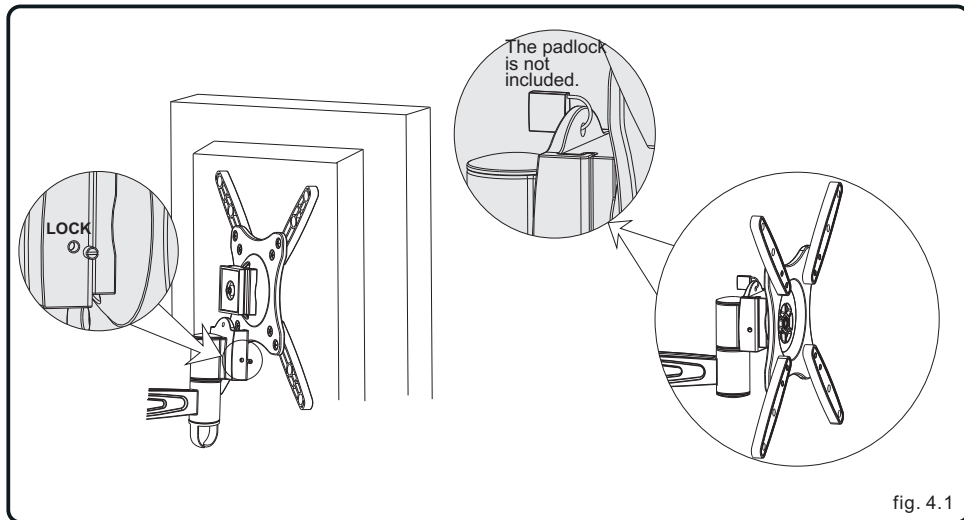

fig. 4.1

5 Pitching angle adjustment

The pitching angle can be adjusted between -15° ~ $+15^{\circ}$, swivel: 180° , pivot: 360° , as shown in fig. 5.1.

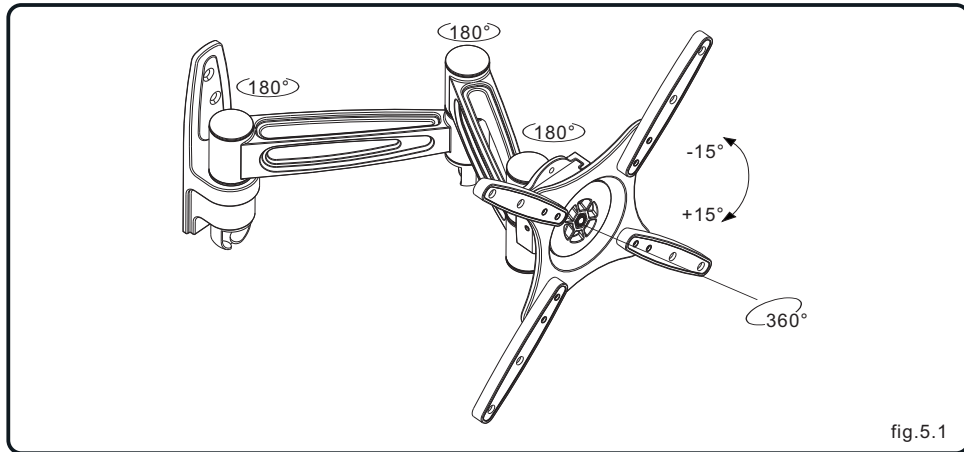

fig.5.1

Maintenance

Once you have mounted the bracket and the flat screen, check that they are sufficiently secure and safe to use. You should check whether screws are fixed well each two months. If you have any doubts regarding the installation, please consult our retailer or service department for detail.



Model nr.:
TVS-HQ-FSB01B
TVS-HQ-FSB02B
TVS-HQ-FSB-16B

INSTALLATION INSTRUCTIONS

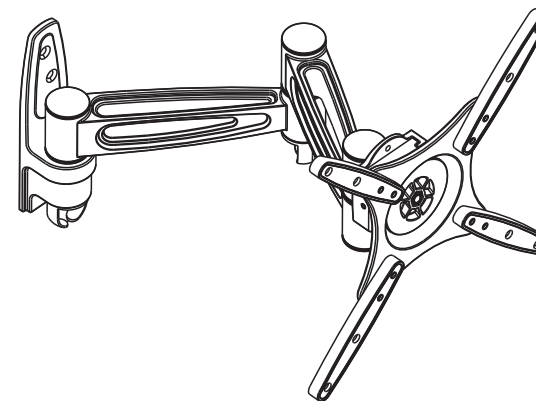

Pitching angle:
 -15° ~ $+15^{\circ}$
Swivel: 180°
Pivot: 360°

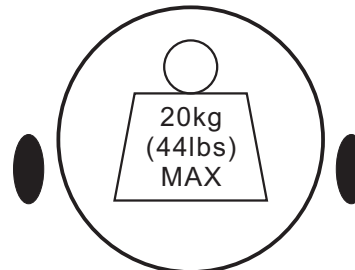

LCD Wall Mount

M

NOTE: Read entire instruction sheet before you start installation and assembly.

WARNING

- Do not begin to installation of the product on you have read and understand the instructions and warnings contained in this Installation Sheet. If you have any question regarding any of the instruction or warning, Please contact your local distributor.
- Please refer to manufacturer's installation guide recommendation for required distance from wall to avoid risk of property damage.
- This product should only be installed by someone of good mechanical aptitude, with experience and basic building, and fully understands.
- Make sure that the supporting surface will safely support the combined load of the equipment and all attached hardware and components.
- Never exceed the Maximum Load Capacity.
- If mounting to wood wall studs, make sure that mounting screws are anchored into the center of the studs. Use of an "edge to edge" stud finder is highly recommended.
- Always use an assistant or mechanical lifting equipment to safely lift and position equipment.
- Tighten screws firmly, but do not over tighten. Over tightening can damage the items, greatly reducing their holding power.
- This product intended for indoor use only. Using this product outdoors could lead to product failure and personal injury.

Component Checklist

IMPORTANT: Ensure you have received all parts against the component checklist prior to installing. If any parts are missing or faulty, telephone the special franchiser for a replacement.

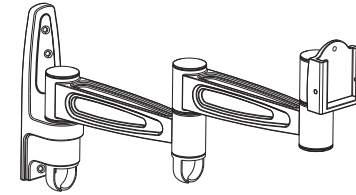

articulated arm
assembly (x1)
A

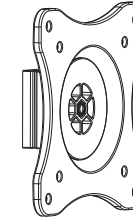

adapter bracket (x1)
B

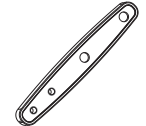

adapter arm (x4)
C

Package M



M4x14 (x4)
M-A



M5x10 (x8)
M-B



M5x14 (x4)
M-C



M6x14 (x4)
M-D

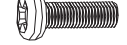

M8x15 (x4)
M-E



D4 (ø4.5xø9)
washer (x4)
M-F



D5 (ø5.5xø12)
washer (x4)
M-G



D6 (ø6.6xø12)
washer (x4)
M-H



ø13.5xø5.5x3.2 (x4)
M-I

Package W

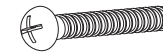

ST5.5x50 lag bolt (x3)
W-A



concrete anchor (x3)
W-B

Tools required

- Phillips Head Screw driver(200mm length exclude the handle)
- Electric drill and 8mm masonry bit for concrete wall installation
- Marking Pen
- Hammer

1a WOOD STUD WALL MOUNTING:

⚠ WARNING

- Make sure that the supporting surface will safely support the combined load of the equipment and all attached hardware and components.
- Tighten wood screws firmly, but do not over tighten. Over tightening can damage the screws, greatly reducing their holding power.
- Make sure that mounting screws are anchored into the center of the studs. Use of an "edge to edge" stud finder is highly recommended.
- Hardware provided is for attachment of mount through standard thickness drywall or plaster into studs. Installers are responsible to provide hardware for other types of mounting situations.

- Use a stud finder to locate the edges of the studs. Use of an edge-to-edge stud finder is highly recommended. Based on their edges, draw a vertical line down the stud's center.
- Place wall plate on wall as a template. And mark the center of the three mounting holes. Make sure that the mounting holes are on the stud centerline.
- Drill three 1/8" (3mm) dia. Holes 1.2" (30mm) deep. Make sure that the wall plate is level, secure it using three wood screws (W-A) as shown in fig. 1.1.

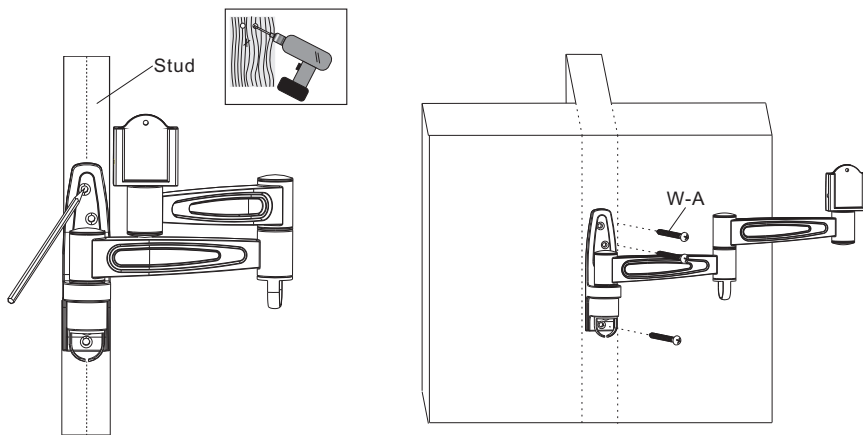

fig. 1.1

1b SOLID BRICK AND CONCRETE BLOCK MOUNTING:

⚠ WARNING

- When installing wall mounts on cinder block, verify that you have a minimum of 1-3/8" of actual concrete thickness in the hole to be used for the concrete anchors. Do not drill into mortar joints! Be sure to mount in a solid part of the block, generally 1" minimum from the side of the block. It is suggested electric drill on slow setting is used to drill the hole instead of a hammer drill to avoid breaking out the back of the hole when entering a void or cavity.
- Installer must verify that the supporting surface will safely support the combined load of the equipment and all attached hardware and components.

- Use the Wall Plate as a template to mark three holes locations on the wall, as shown in fig. 1.2.
- Pre-drill these holes with a 8mm masonry bit to at least 50mm in depth. Insert a Concrete Anchor (W-B) into each of these holes. Attach the Wall Plate to the wall using three wood screws (W-A), as shown in fig. 1.3.

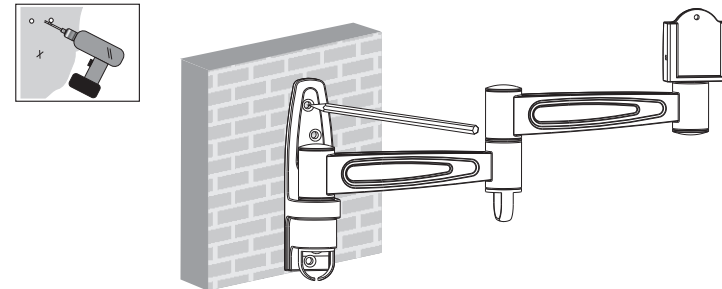

fig. 1.2

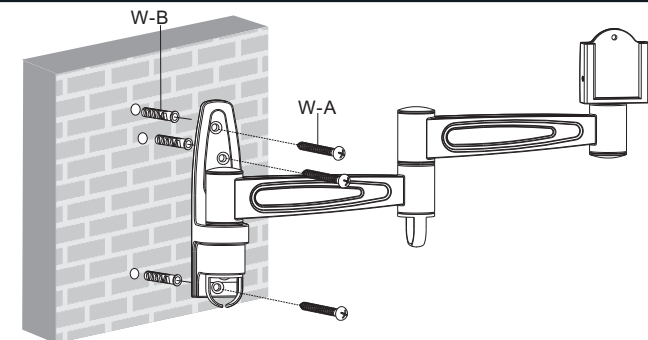

fig. 1.3

2 Assembling Adapter Arms

2a, For VESA 200X200

place the four adapter arms on the adapter bracket and align to mounting holes. Using eight appropriate combination of screws, and then tighten screws. Do not over tighten! as shown in fig.2.1

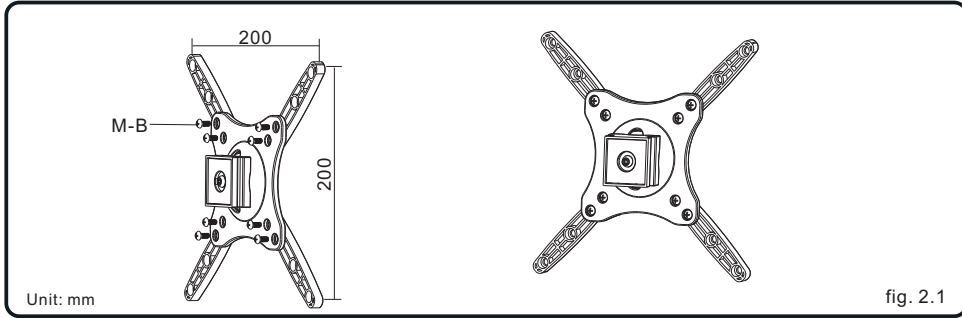

fig. 2.1

2b, For VESA 200X100

place the four adapter arms on the adapter bracket and align to mounting holes. Using four appropriate combination of screws, adjust the level of adapter arms, and then tighten screws, Do not over tighten! as shown in fig.2.2

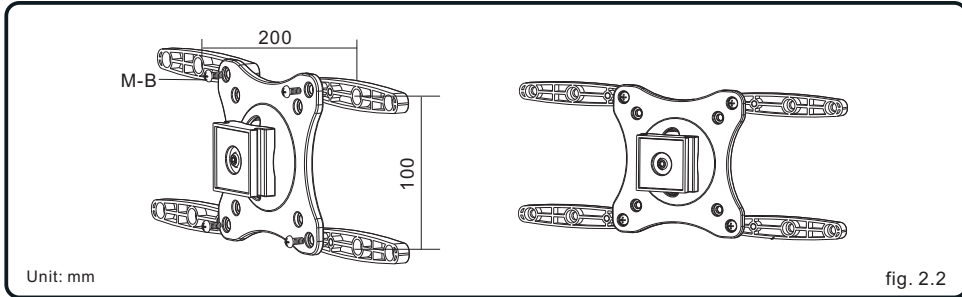

fig. 2.2

3 Installing Adapter Bracket

- To prevent scratching the screen, set a cloth on a flat, level surface that will support the weight of the screen.
- Place screen face side down. Place the adapter bracket on the back of screen, align to holes, as shown in fig.3.1
- Attach the adapter bracket to the back of the screen using appropriate combination of screws. as shown in fig.3.2, fig.3.3, fig.3.4, fig.3.5, fig.3.6, fig.3.7, fig.3.8 and fig.3.9.

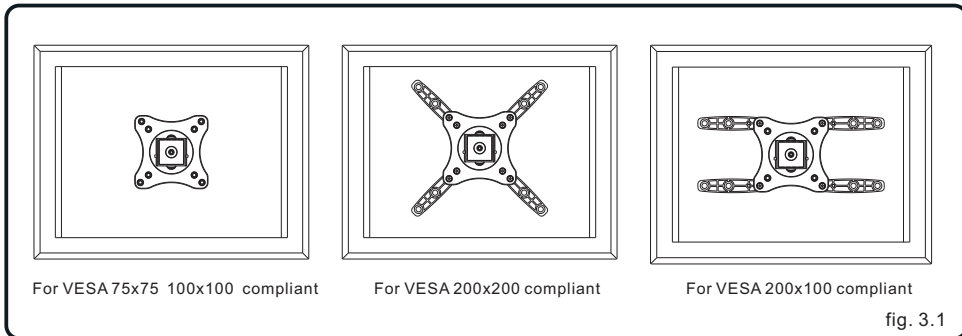

fig. 3.1

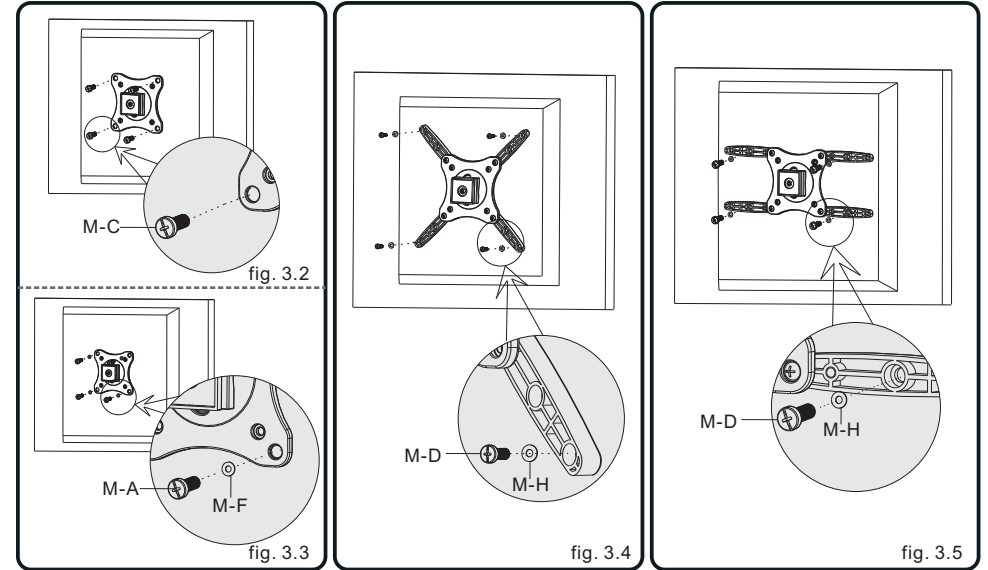

fig. 3.2

fig. 3.3

fig. 3.4

fig. 3.5

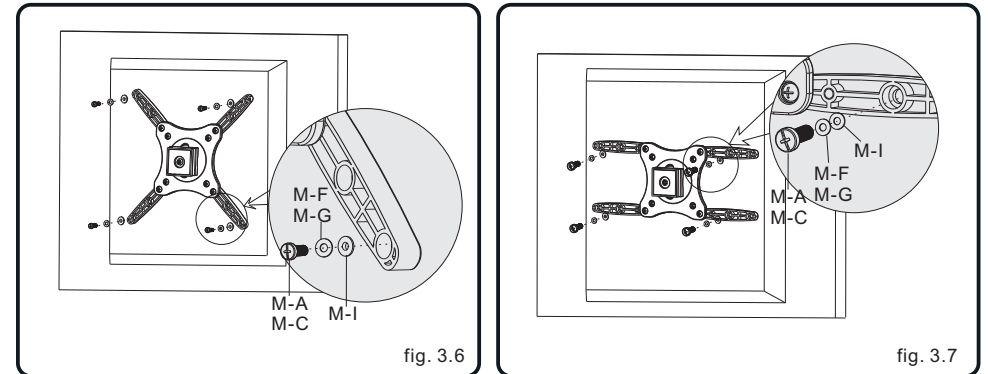

fig. 3.6

fig. 3.7

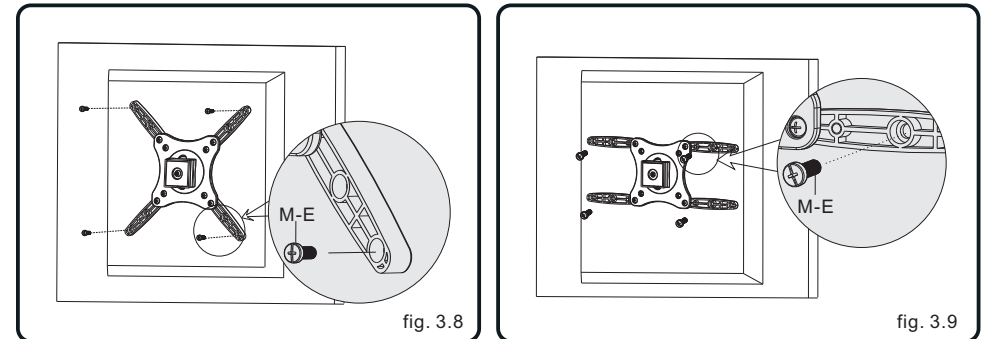

fig. 3.8

fig. 3.9